

3D PRINTING ISN'T JUST FOR PROTOTYPING ANYMORE

INDUSTRY SPOTLIGHT:

3D PRINTED FIXTURES & JIGS

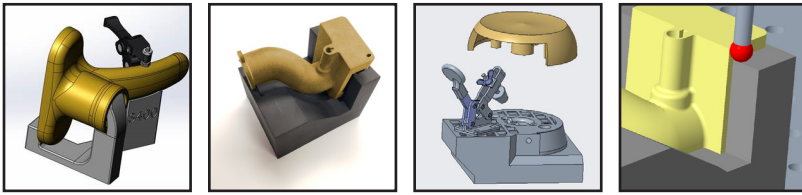

Benefits of 3D Printed Fixture Components:

- Increased productivity, fast change-over for CNC cells
- Reduction in waste
- Improved accuracy and repeatability
- Better worker safety
- Easier for operator
- Accurate part placement
- Stiff yet lightweight
- Ergonomic design with complex organic shapes
- Threaded inserts or holes for attaching brackets
- Wear-resistant material that will not damage parts

Applications:

- Light CNC operation fixture assemblies
- Bench top fixtures
- Robotic arm grippers
- Hand held assembly device
- CMM inspection fixtures
- Clearance gauges
- Cut off fixtures

GET AN INSTANT QUOTE

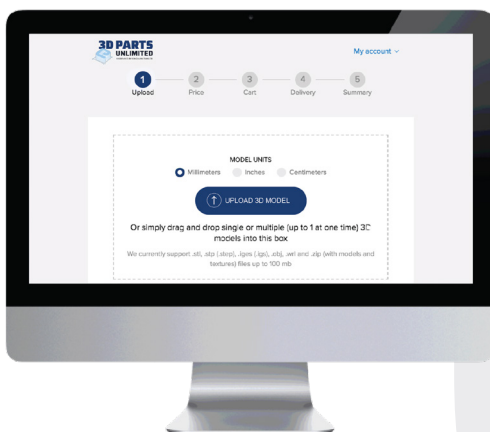

QUICKER QUOTES MEAN FASTER DELIVERY

RECEIVE YOUR QUOTE IN FIVE EASY STEPS.

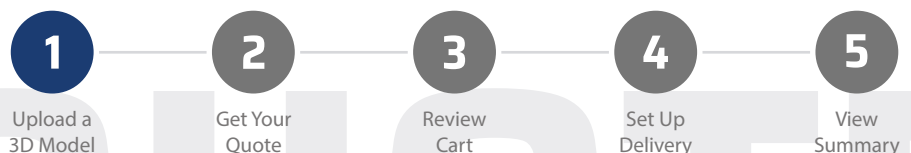

Visit 3dpartsunlimited.com/instant-quote to get started.

CAPABILITIES

3D Parts Unlimited leverages various technologies to produce reliable, rugged, high quality plastic & metal parts.



HP MULTI JET FUSION

Designed by HP, this technology unlocks the full potential that 3D printing has to offer.

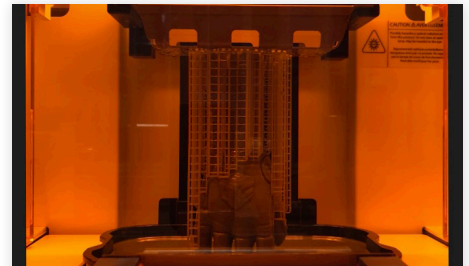

DIRECT LIGHT

DLP on our figure 4 will give exceptional surface finish and six sigma repeatability.

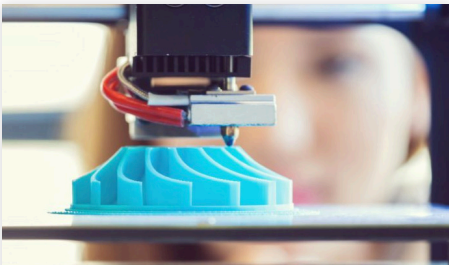

FUSED DEPOSITION MODELING

FDM utilizes a filament that's heated in a nozzle and then extruded layer by layer until the part is fully built.



SELECTIVE LASER SINTERING

SLS is a powder-based technology that uses a CO2 laser to sinter each layer together.



DIRECT METAL LASER SINTERING

DMLS is ideal for creating end-use parts that hold all characteristics of regular machined metal parts.

INDUSTRIES WE SERVE



AEROSPACE
& DEFENSE



CONSUMER
PRODUCTS



ARCHITECTURE



MEDICAL



TOOLING
& INDUSTRIAL



TRANSPORTATION



CONTACT US

W142N9351 Fountain Blvd,
Menomonee Falls, WI 53051



(262)-255-9300

3dpartsunlimited.com